

STORM MEDIUM MOON DIMMABLE

DATA

Collection	STORM SYSTEM®
Product	Storm Medium Moon – Dimmable
Article no.	1N01.0108.3265

SPECIFICATIONS

Weight	13.1 oz
Materials	Aluminium and natural stone
IP protection grade	IP20
Labelling	



Conforms to ANSI/UL
Std. UL 2108:2015

Cert. to CAN/CSA
Std. CSA C22.2#250.13:2017

Intertek
5005519

Fixture finish	Alabaster
Light Source	LED Constant Current (included) For IES/LDT lux files review STORM SYSTEM® – LUX FILES ➤
Supply	5W 33V 130mA
CCT	2500K (nature stone – variations can occur!)
Insulation class	Class III

ADDITIONAL REQUIREMENTS (NOT INCLUDED)

Junction kit	review STORM SYSTEM® – CONFIGURATION ➤
--------------	--

For further support contact LITES ON WEST
245 West 29th Street, 6th floor | NY, NY 10001
T: 212 775 6363 | F: 212 775 0355
E: info@litesonwest.com

This product shall always be powered by SELV LED driver, output voltage of this driver in open circuit must not exceed 60V. Do NOT cover the LED driver or locate LED driver on top of light fixture.

NOTE

Be cautious while putting on/off the power supply, as excess current, excess voltage or reverse voltage may get injected to the device in some cases.

The light source of this light fixture is not replaceable; when the light source reaches its end of life the whole light fixture must be replaced.

INSTALLATION DEPTH

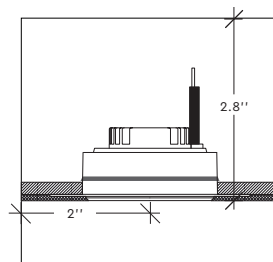

STORM SYSTEM®

The Storm Medium Moon is part of the STORM SYSTEM® MEDIUM collection. A collection that includes a wide range of special designed products. The STORM SYSTEM® collection is carefully designed to flush the surface of any ceiling or wall, and all products will appear with an absolute minimum of tolerance and visibility.

Storm Medium Moon is designed to flush ceilings or walls. A soft light shines through the alabaster stone, and provides a pleasant light. A perfect solution for a night light.

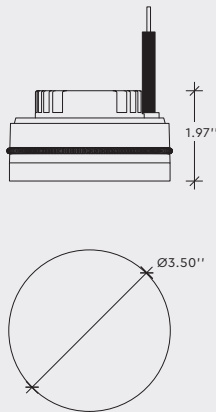

The crossed-out wheeled bin symbol indicates that the item should be disposed of separately from household waste. The item should be handed in for recycling in accordance with local environmental regulations for waste disposal

For more information, please contact info@onea.dk



STORM SYSTEM®

The Storm Medium Moon is part of the STORM SYSTEM® MEDIUM collection. A collection that includes a wide range of special designed products. The STORM SYSTEM® collection is carefully designed to flush the surface of any ceiling or wall, and all products will appear with an absolute minimum of tolerance and visibility.

Storm Medium Moon is designed to flush ceilings or walls. A soft light shines through the alabaster stone, and provides a pleasant light. A perfect solution for a night light.

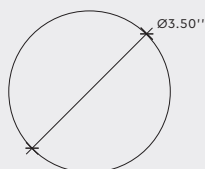
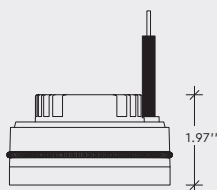

The crossed-out wheeled bin symbol indicates that the item should be disposed of separately from household waste. The item should be handed in for recycling in accordance with local environmental regulations for waste disposal

For more information, please contact info@onea.dk

STORM MEDIUM MOON DIM TO WARM

DATA

Collection	STORM SYSTEM®
Product	Storm Medium Moon – Dim to Warm
Article no.	1N01.0108.3266

SPECIFICATIONS

Weight	13.1 oz
Materials	Aluminium and natural stone
IP protection grade	IP20
Labelling	



Conforms to ANSI/UL
Std. UL 2108:2015

Cert. to CAN/CSA
Std. CSA C22.2#250.13:2017

5005519

Fixture finish	Alabaster
Light Source	LED Constant Current (included) For IES/LDT lux files review STORM SYSTEM® – LUX FILES ➤
Supply	5W 33V 130mA
CCT	2500 – 2000K (nature stone – variations can occur!)
Insulation class	Class III

ADDITIONAL REQUIREMENTS (NOT INCLUDED)

Junction kit review STORM SYSTEM® – CONFIGURATION ➤

For further support contact LITES ON WEST
245 West 29th Street, 6th floor | NY, NY 10001
T: 212 775 6363 | F: 212 775 0355
E: info@litesonwest.com

This product shall always be powered by SELV LED driver, output voltage of this driver in open circuit must not exceed 60V. Do NOT cover the LED driver or locate LED driver on top of light fixture.

NOTE

Be cautious while putting on/off the power supply, as excess current, excess voltage or reverse voltage may get injected to the device in some cases.

The light source of this light fixture is not replaceable; when the light source reaches its end of life the whole light fixture must be replaced.

INSTALLATION DEPTH

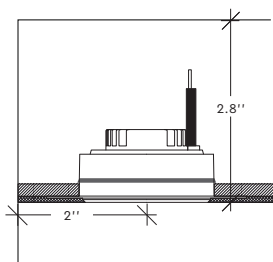

IMPORTANT INFORMATION

Installation and mounting must be performed by a certified electrician only, and instructions must be followed.

Always make sure the main power is off during installation. Pay attention to the fixture remarks, and always make sure to use the correct voltage.

CLEANING AND MAINTENANCE:

Use a soft moist cloth for cleaning. No further maintenance is required.

WARRANTY:

If the product is defect, please contact your supplier immediately. Please note that warranty will not apply in case of wrongful use or if unskilled personnel attempts to repair.

COMPONENTS

- Storm Medium Moon
- Suction cup for disassembly

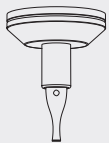
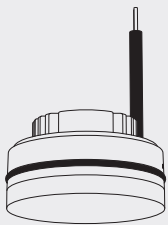

PLEASE NOTE:

If the spring on the fixture is damaged, do not proceed installation – contact your dealer!

STORM MEDIUM MOON

ASSEMBLY INSTRUCTION

STEP 1

Make sure main power is off!

Mount the chosen junction kit.

Mount the fixture into the plaster ring/backmounted ring. Do this by slightly rotating the fixture into the plaster ring/back-mounted ring.

NOTE: When rotating the fixture choose the direction with the least resistance.

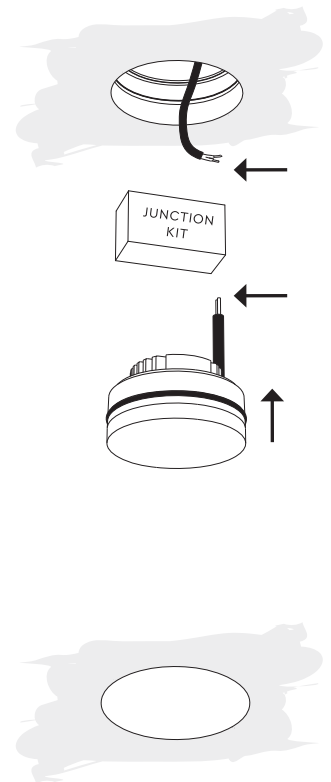

IMPORTANT INFORMATION

Disassembly must be performed by a certified electrician only, and instructions must be followed. Always make sure the main power is off during installation. Pay attention to the fixture remarks, and always make sure to use the correct voltage.

WARRANTY:

If the product is defect, please contact your supplier immediately. Please note that warranty will not apply in case of wrongful use or if unskilled personnel attempts to repair.

STORM MEDIUM MOON

DISASSEMBLY INSTRUCTION

STEP 1

Make sure main power is off!
Place the suction cup over the fixture.

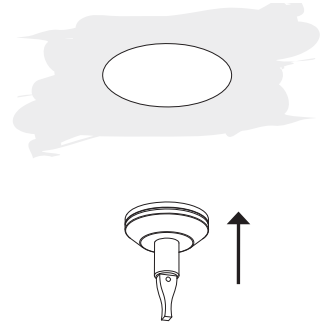

STEP 2

Turn the handle to ensure suction, then pull down gently, whilst slightly rotating.

NOTE: When rotating the fixture choose the direction with the least resistance.

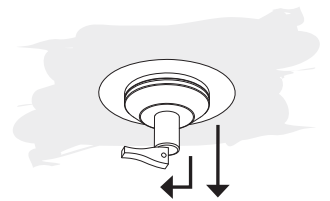

STEP 3

Disconnect the cables

